

Pluro Single Lever Pull Out Spray

abode

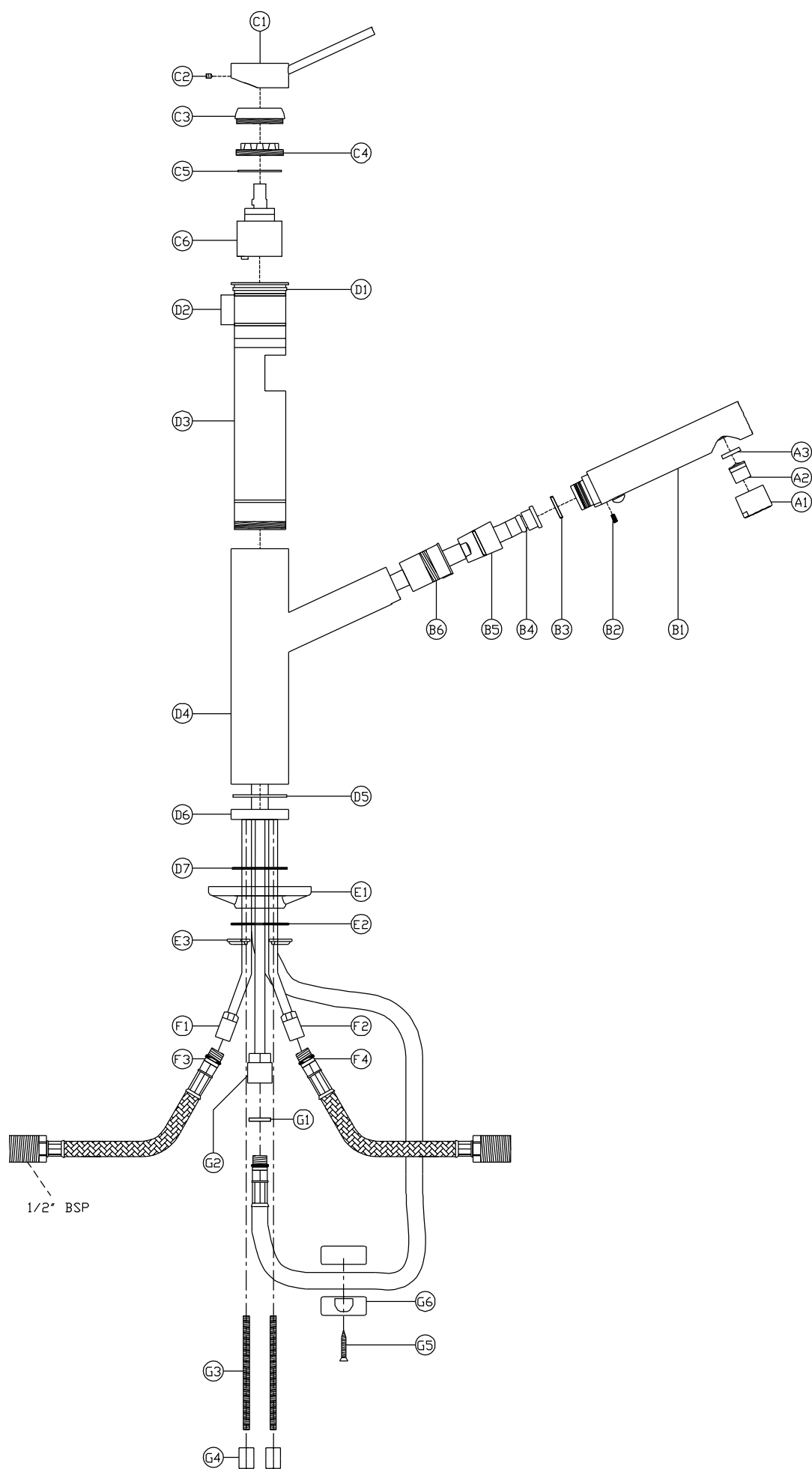

# Pluro Single Lever Pull Out Spray

abode

## General Advice:

- These instructions are intended as a guide only, if you are in any doubt you should seek the advice of a qualified professional.
- Take care not to mark finished parts with screwdrivers or other tools.
- Use a pair of rubber gloves to get a better grip on decorative hand tight parts.
- Ensure all parts are reassembled tightly.
- After maintenance test that all assemblies are water tight and function correctly.
- Always isolate the hot and cold water supplies before starting any maintenance, once isolated you should drain any residual water from your system.

## To replace the hot and cold valve:

1. Loosen grub screw (C2) on the side of handle (C1) using a 2.0mm A/F allen key.
2. Pull the handle (C1) vertically away from the tap body (D4).
3. Unscrew valve cover (C3) by hand vertically away from tap body (D4).
4. Hold the body of tap (D4) firmly. Using an adjustable spanner unscrew the valve lock nut (C4).
5. Clean the Inside of chamber (D3) with a soft wet cloth.
6. Reassemble the tap in the reverse order replacing valve (C6).

## To replace the hose:

1. Disconnect hose (B4) from outlet adaptor (G2).
2. Unscrew hose nut (B5) from spray head (B1) by hand.
3. Pull hose (B4) away from tap body (D4) passing hose (B4) through tap body (D4).
4. Reassemble the tap in the reverse order replacing the hose (B4). Ensure to replace rubbers washers (B3) and (G1).